

# Z33X-SBSH

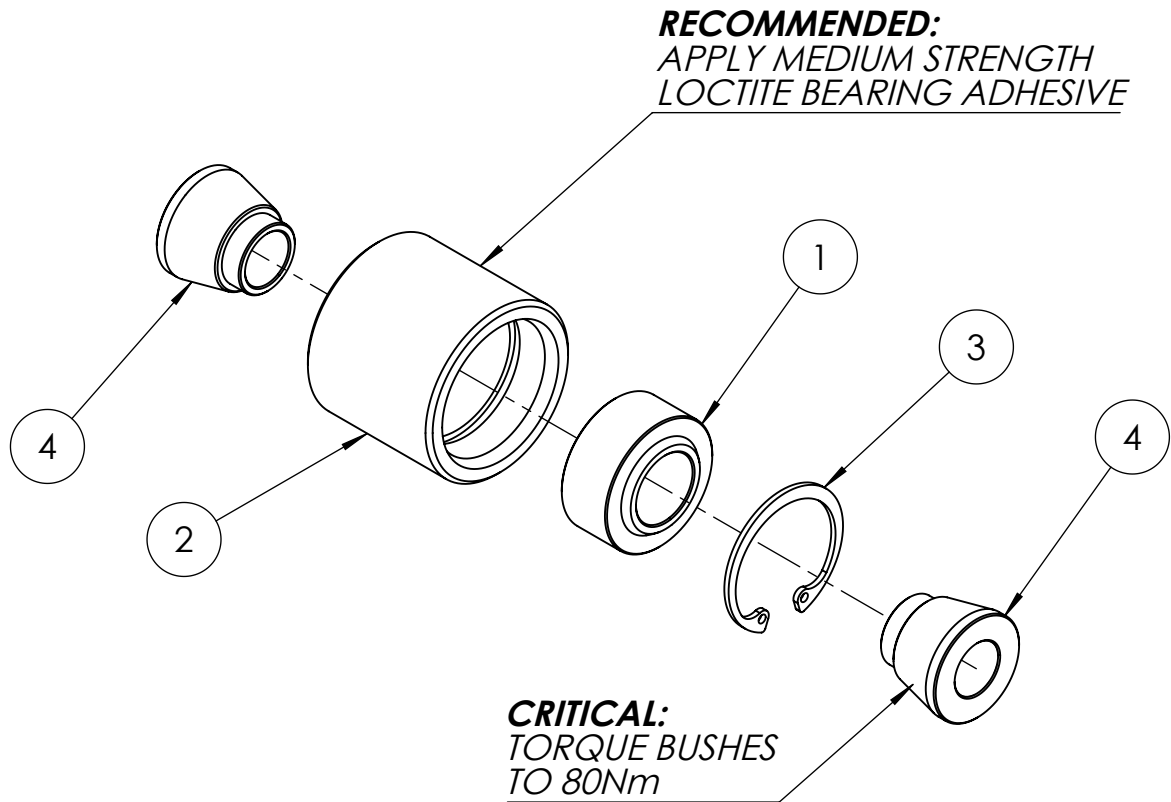

## DIAGRAM A

1. PRESS OUT THE OEM STRUT BUSHINGS.
2. APPLY LOCTITE BEARING ADHESIVE.  
(MEDIUM STRENGTH IS SUFFICIENT) \*RECOMMENDED.
3. PRESS IN NEW SPHERICAL BEARINGS. PRESS THE HOUSING IN BY APPLYING FORCE ON THE OUTER EDGE.

ITEM NO.	DESCRIPTION:	QTY.
1	COM10-T SPHERICAL BEARING	2
2	350Z FRONT LOWER ARM INNER BEARING HOUSING	2
3	DIN 472, INTERNAL RETAINING RING	2
4	COM10T SPACER 12.2x44.75 - LM	4