

Z33X-WBKT

MATERIALS:

BRACKET - 6061-T6 ALUMINIUM

KNUCKLE - A356 ALUMINIUM

RECOMMENDED FILLER MATERIAL:

4043 or 5356

!!!NOTE!!!

CERTAIN MODELS OF 370 MAY REQUIRE
SLIGHT GRINDING FOR WELD ON BRACKET
TO LINE UP CORRECTLY

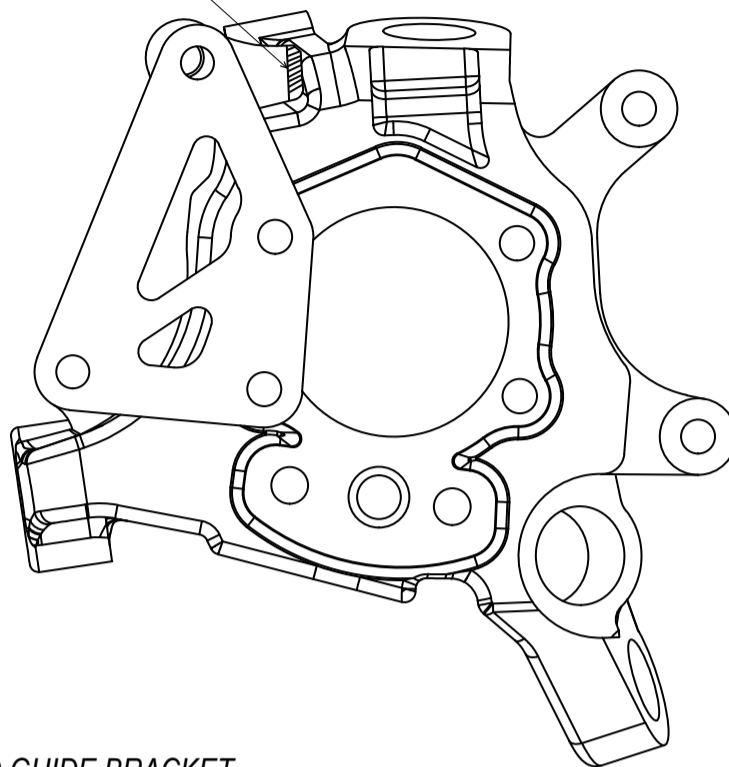

2. MOUNT BRACKET WITH WELD GUIDE BRACKET,
USING M12x40 BOLTS AND INCLUDED NUTS. IF
WELD GUIDE BRACKET IS NOT USED, OFFSET
FROM WHEELHUB MOUNTING PLANE IS 7,5mm

4. WELD ALONGSIDE THE BRACKET
AS FAR AS CAN BE REACHED

1. REMOVE ALL COMPONENTS
FROM THE KNUCKLE,
INCLUDING TOE LINK BUSHING

3. WELD THE ENDS OF THE BRACKET
AND TWO SPOT WELDS IN THE MIDDLE

WHEELHUB PLANE

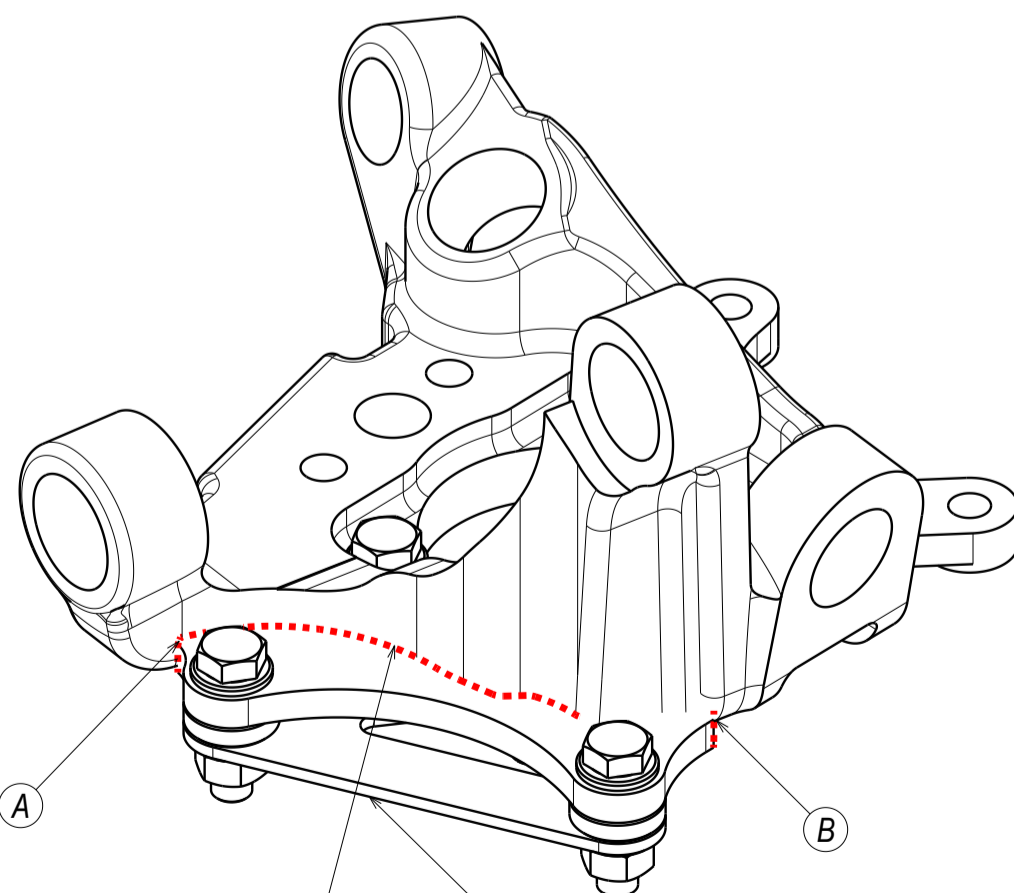
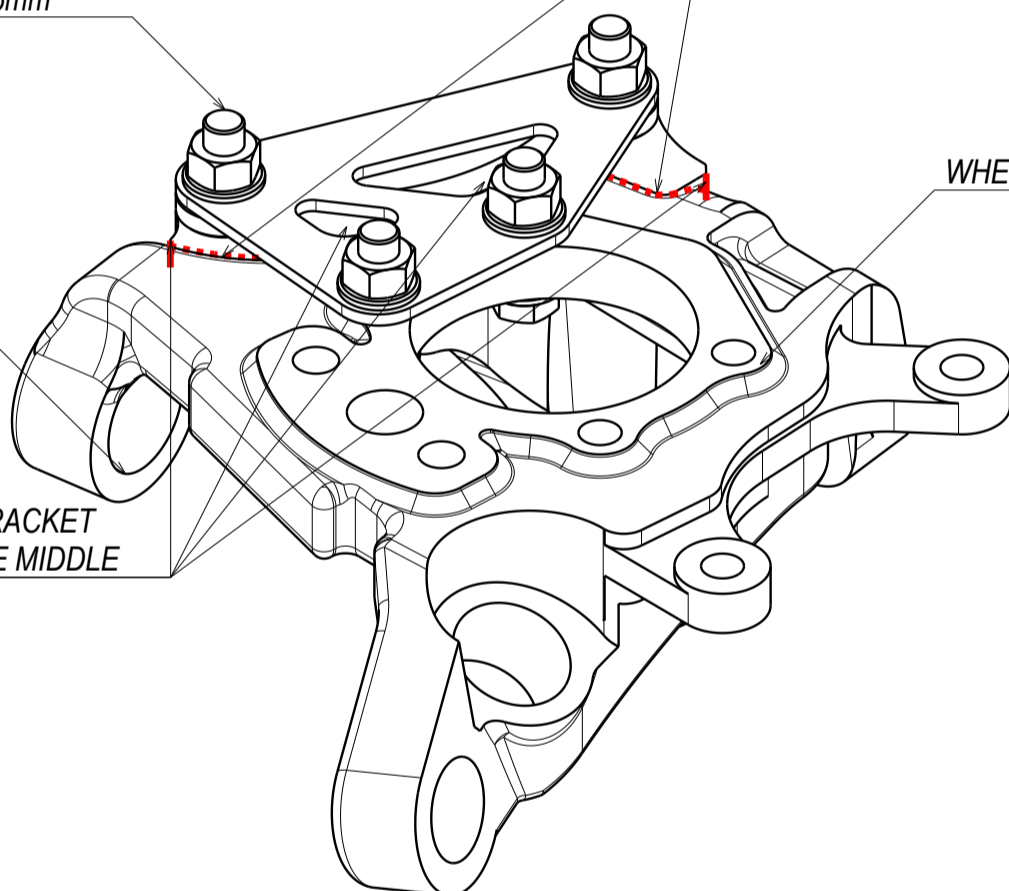

5. WELD FROM A TO B

6. COOL DOWN THE KNUCKLE AT AIR TEMP AND REMOVE BOLTED
COMPONENTS. CHECK FOR WARPING DUE TO HEAT BY MEASURING
OFFSET FROM THE WHEELHUB PLANE. $8\text{mm} \pm 0,2$